



ClearSpan™ Fabric Room Divider Installation Guide



Actual room divider may differ from the example shown above.



READ THIS DOCUMENT BEFORE YOU BEGIN!

Thank you for purchasing this ClearSpan™ Fabric Room Divider. This guide includes helpful hints and important information needed to safely attach and properly maintain the purchased room divider components. Please read these instructions **before** you begin.

If you have any questions during the assembly, contact customer service for assistance.

SAFETY PRECAUTIONS

- Wear eye protection.
- Wear head protection.
- Wear gloves when handling metal components.
- Use a portable GFCI (Ground Fault Circuit Interrupter) when working with power tools and cords.
- Do not store hazardous materials in the shelter after installing room divider unless properly vented.
- Provide proper ingress and egress to prevent entrapment.

⚠ WARNING: The individuals assembling this room divider are responsible for designing and furnishing all temporary bracing, shoring and support needed during the assembly process. For safety reasons, those who are not familiar with recognized construction methods and techniques must seek the help of a qualified contractor.

FABRIC ROOM DIVIDER AND RELATED COMPONENTS

The design and size of the room divider, the installation method and mounting surface, and whether the divider will open and close all determine which parts and fasteners are needed. This installation guide describes some common components used to install a typical room divider.

ATTENTION: It is the responsibility of the customer/owner/installer to accurately describe to the representative *at the time of purchase* how the divider will be used and attached. ***The mounting surface must be able to support the fabric room divider, the related components, and the forces produced when the divider is in use.***

Consult the services of a qualified contractor before installation to determine the best and safest way to install the divider.

Additional considerations and questions:

- What are the dimensions of the opening that will be covered by the fabric room divider? (Consider the mounting method when determining the size of the room divider panel.)
- Will the room divider consist of a single panel, or are multiple panels needed?
- Will the room divider panel fit within the framed opening, or will it overlap the frame at any point? (Customer must determine how the divider is to divide the spaces.)
- How will the divider be secured to the room or building?
- Does the lower edge of the divider need to be anchored in place when the divider is installed and closed?
- Does the divider need to be opened and closed regularly?
- If the divider needs to open and close, will access be at one or both edges?
- Are there any obstacles that could prevent the installation of the room divider?
- Will the customer supply the fasteners required to properly and safely secure the room divider, or will fasteners be purchased with other curtain components?
- When the divider is closed, does it need to be locked or secured in the closed position?
- If pulleys and rope are used to open and close the room divider, what length of rope is required. Consider how the divider is to open and close and its size.
- Is the divider used where livestock is housed?
- Will the divider be exposed to the forces of nature (wind, rain, snow, ice, etc.)?

ASSEMBLY PROCEDURE

The steps below describe attaching a typical room divider. *There is no specific kit for the room divider.* Components are based on information provided by the customer at the time of purchase. The following is a recommended installation method with suggested parts and components. Notify customer service with questions or concerns.

ATTENTION: Fabric room dividers are specific to the customer's needs and are ordered based on those needs. The frame and room dividers shown throughout this guide may differ from your frame and room divider. *It is the responsibility of the owner/installer to adapt these steps as needed to attach the actual room divider.*

Depending on the shelter, some components may differ from actual components. In such instances, purchase additional parts and fasteners locally. Or, contact your sales representative to purchase additional parts and for more information.

1. Read these instructions and additional documentation (if any) included with the shipment **before** you begin.
2. Gather the tools, bracing, ladders (and lifts), and assistants needed to reach the top of the shelter to install the room divider.
3. Attach the fabric room divider.
4. Read the care and maintenance information at the end of these instructions.
5. Complete and return all warranty information and documentation as instructed (if present).

REQUIRED TOOLS

The following list identifies the main tools needed to assemble and attach a typical fabric room divider. *Additional tools and supports may be needed depending on the structure, location, and room divider size and design.*

- Tape measure or measuring device
- Variable speed drill and impact driver (cordless with extra batteries works best)
- Cable cutter (if cable is present) and metal-cutting saw
- Scissors or utility knife to cut strap
- Hammers, gloves and eye protection
- Ladders, work platforms, and other machinery for lifting designed to work safely at the height of the opening.

ATTENTION: Consult the services of a qualified, professional contractor if you are not familiar with the installation of similar components.



The parts shown below are used in a typical room divider installation. The width and height of the room and the divider panel design determines the components needed to install the room divider. Suggested parts include *but are not limited to* the items listed below:



100380
Box Track Bracket



100377, 100379, 105588
8', 12', or 16' Box Track



100346
Ball Bearing Carrier



AS2152
Snap Hook



AS5118
Pulley

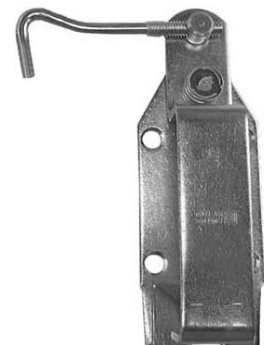

100358
Cam Latch



AS2080
Rope Cleat

Typical Fabric Room Divider Installation

All components shown throughout this guide are purchased by the customer.

Step 1: Slide 100380 track brackets onto the box track. Place one every 4' or so for support.

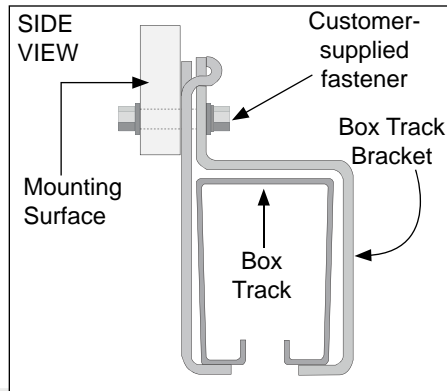
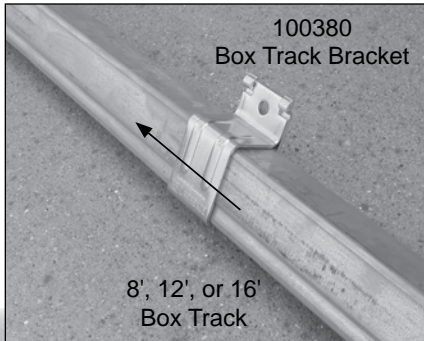

Step 2: Hoist box track into position where it will be attached, verify that it is level and that the track brackets are evenly spaced, and attach using customer supplied fasteners.

NOTE: Bracket fastener depends on the surface that it is attached to. Purchase fasteners accordingly.

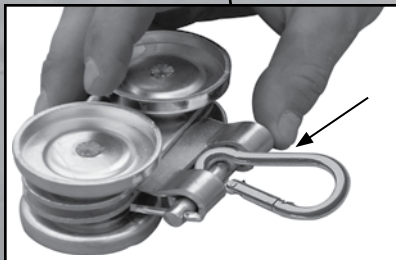
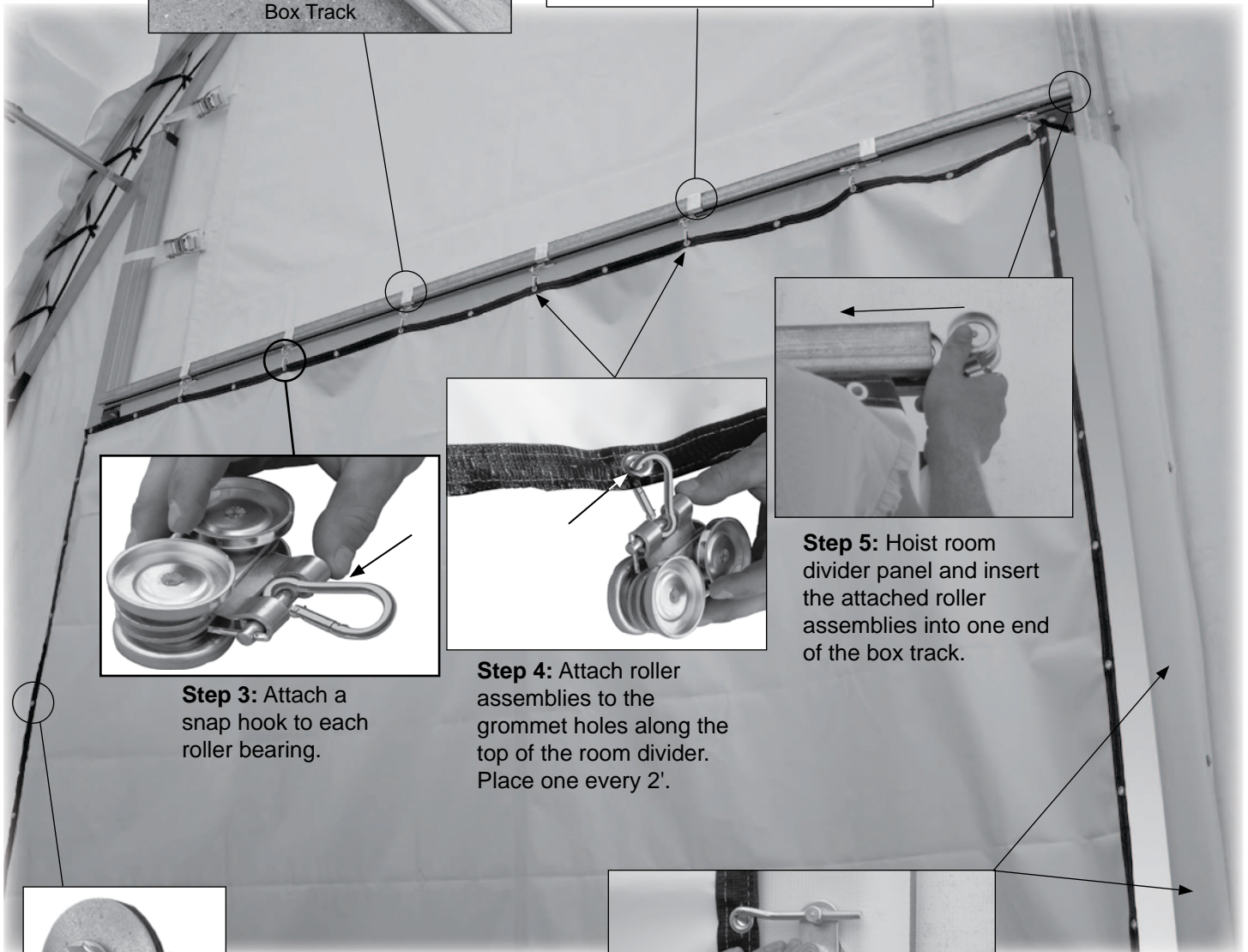

Step 3: Attach a snap hook to each roller bearing.

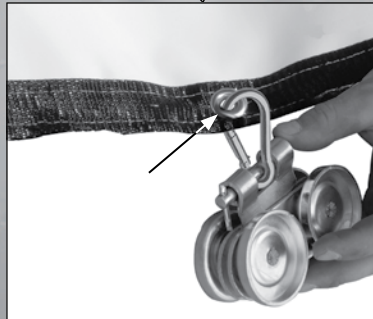

Step 4: Attach roller assemblies to the grommet holes along the top of the room divider. Place one every 2'.

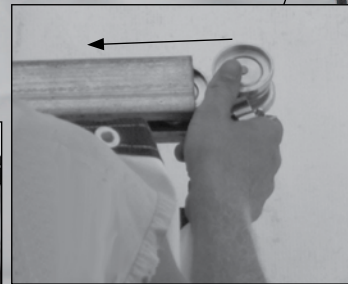

Step 5: Hoist room divider panel and insert the attached roller assemblies into one end of the box track.



Step 6: Determine the side the divider will open toward and secure using Tek screws and neo-bonded washers. (Applies to room dividers that are secured at one or both vertical edges.)



Step 7: Using the room divider grommet holes as guides, install cam-latches to secure room divider when in the closed position.

Opening and Closing a Fabric Room Divider

SINGLE ROPE METHOD

Step 1: Attach AS5118 pulleys in the locations shown using customer-supplied fasteners.

Step 2: Tie one end of rope to the end snap hook on the opening side.

Step 3: Thread rope through the pulleys and snap hooks as shown.

Step 4: Pull tight to remove slack, tie off to the same snap hook indicated in Step 2, and cut excess.

Step 5: Pull down one side to open, and pull down the other side to close.

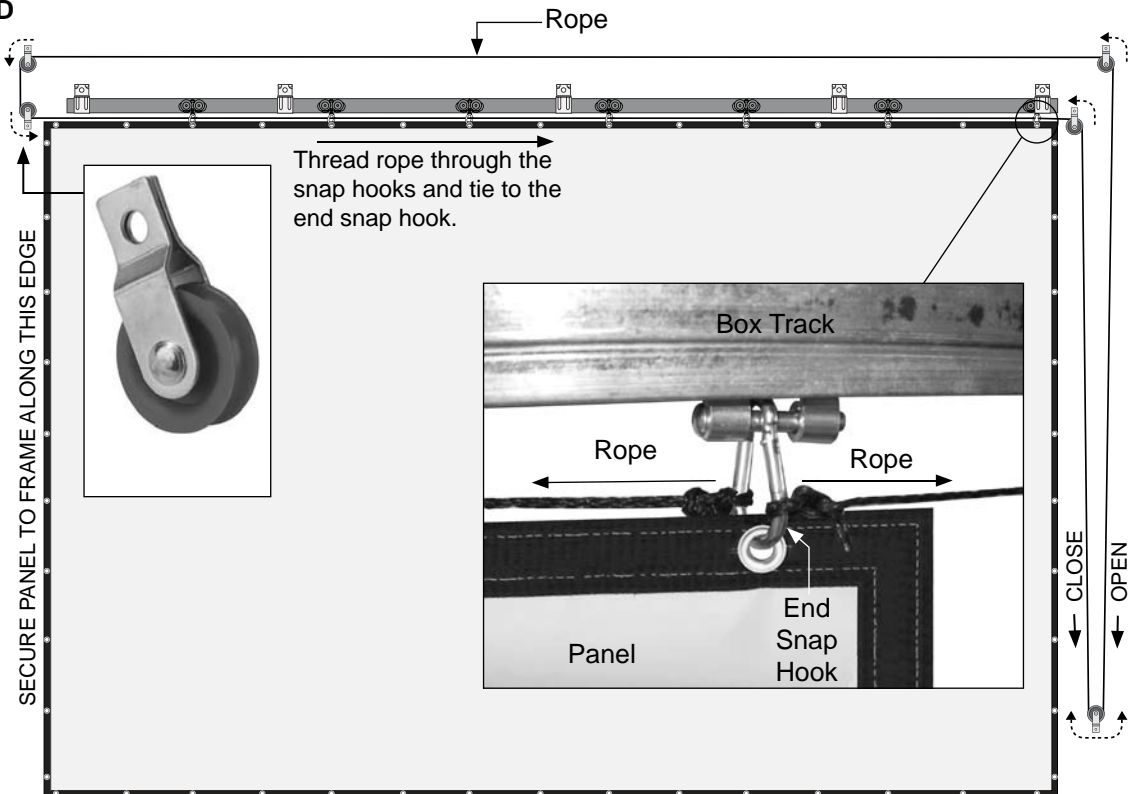

DOUBLE ROPE METHOD

Step 1: Attach pulleys and rope cleats in the locations shown using customer-supplied fasteners.

Step 2: Tie one end of two lengths of rope to the end snap hook on the opening side, and thread through the pulleys and snap hooks as shown.

Step 3: Wrap the ends of the ropes around the rope cleats as shown. Verify both ropes are able to wrap around the cleats whether the room divider is in the open or closed position.

Step 4: To open or close, unwrap both rope ends from the rope cleats, pull down one side to open and pull down the other side to close, and rewrap the rope ends around the cleats once room divider is in the desired position.

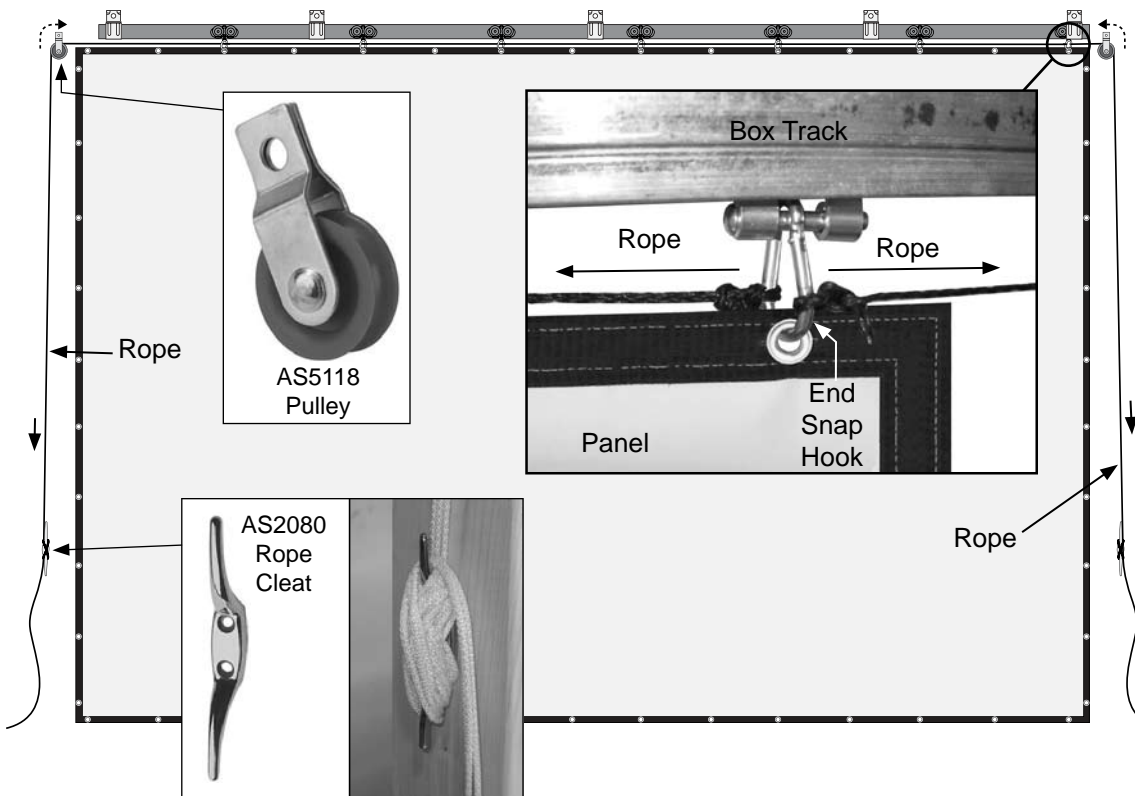

Securing a Fabric Room Divider at Bottom

ANCHORING

If desired, the divider panel can be locked in the closed position using chains anchored in concrete or concrete footings. The customer is responsible for preparing these footings and installing the chain.

NOTE: These instructions describe setting the anchor chains in concrete footings dug into the site. If a concrete floor exists, or footings or walls are present, the owner/building must take additional steps to set the anchor chains used to secure the room divider when it is closed. Consult the services of an experienced professional contractor if needed to properly secure the anchor chains to the site. The steps below describe one way to install the chains to secure the room divider panel.

1. With the panel in the closed position, mark on the ground the locations of each connection point.

NOTE: Position chains below grommet holes if possible. Space chains as desired. Typically, larger dividers require more anchors, especially if wind passes through the building when large doors are opened and closed.

2. At each mark, use an auger to drill an anchor hole. Different steps are required if a concrete floor is present.
3. Locate the customer-supplied bulk chain and divide it evenly based on the number of connection points. Remember to consider the height of the lower edge of the panel when cutting the chain to the needed length.
4. Using the diagram below, insert rebar (or similar bar stock) through the lower chain links of one chain section as shown. These help secure the chain in the hole after concrete is added.
5. Lower one chain into one hole leaving the required length of the chain above grade. (The length of chain remaining above grade depends on the location of the lower edge of the installed panel.) Fill hole with concrete and let the concrete set.
6. Repeat the steps for the remaining chain anchors.
7. With the panel closed, secure the panel to the chain anchors using snap hooks or similar customer-supplied fasteners connected to the grommets of the installed room divider.

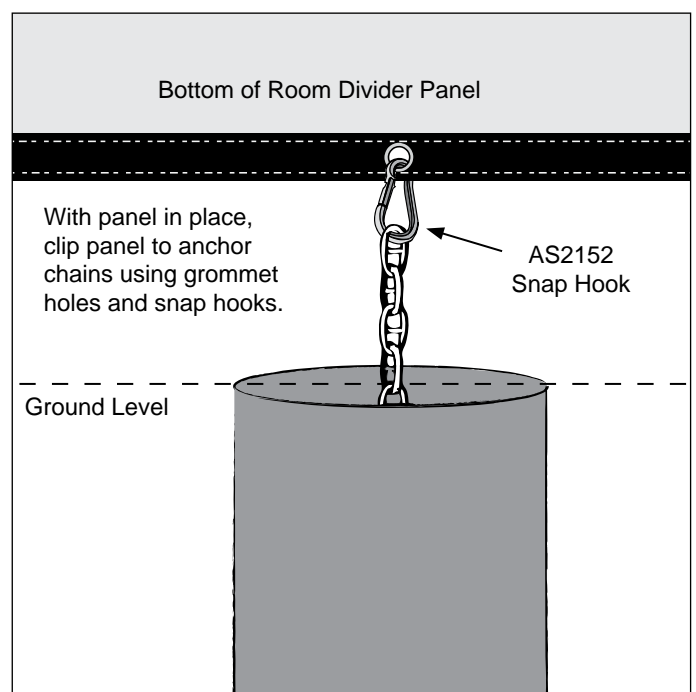
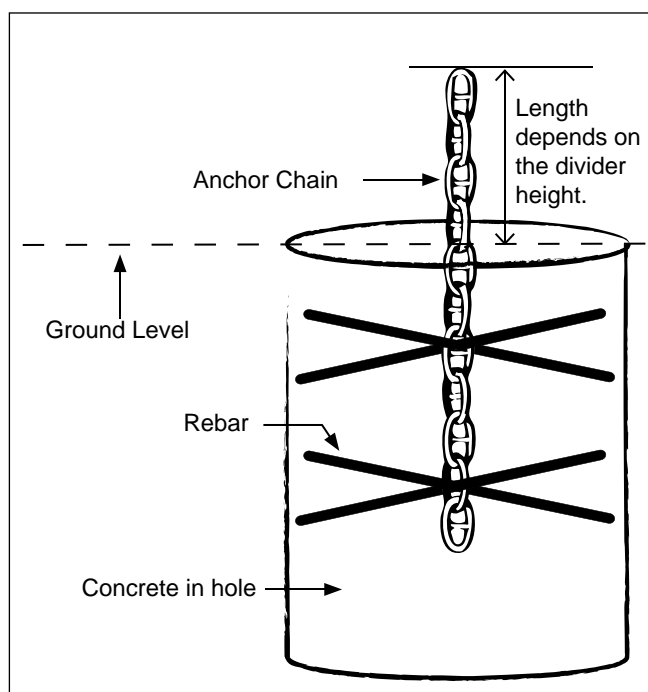

Securing a Fabric Room Divider at Bottom

CABLE & SNAP HOOKS

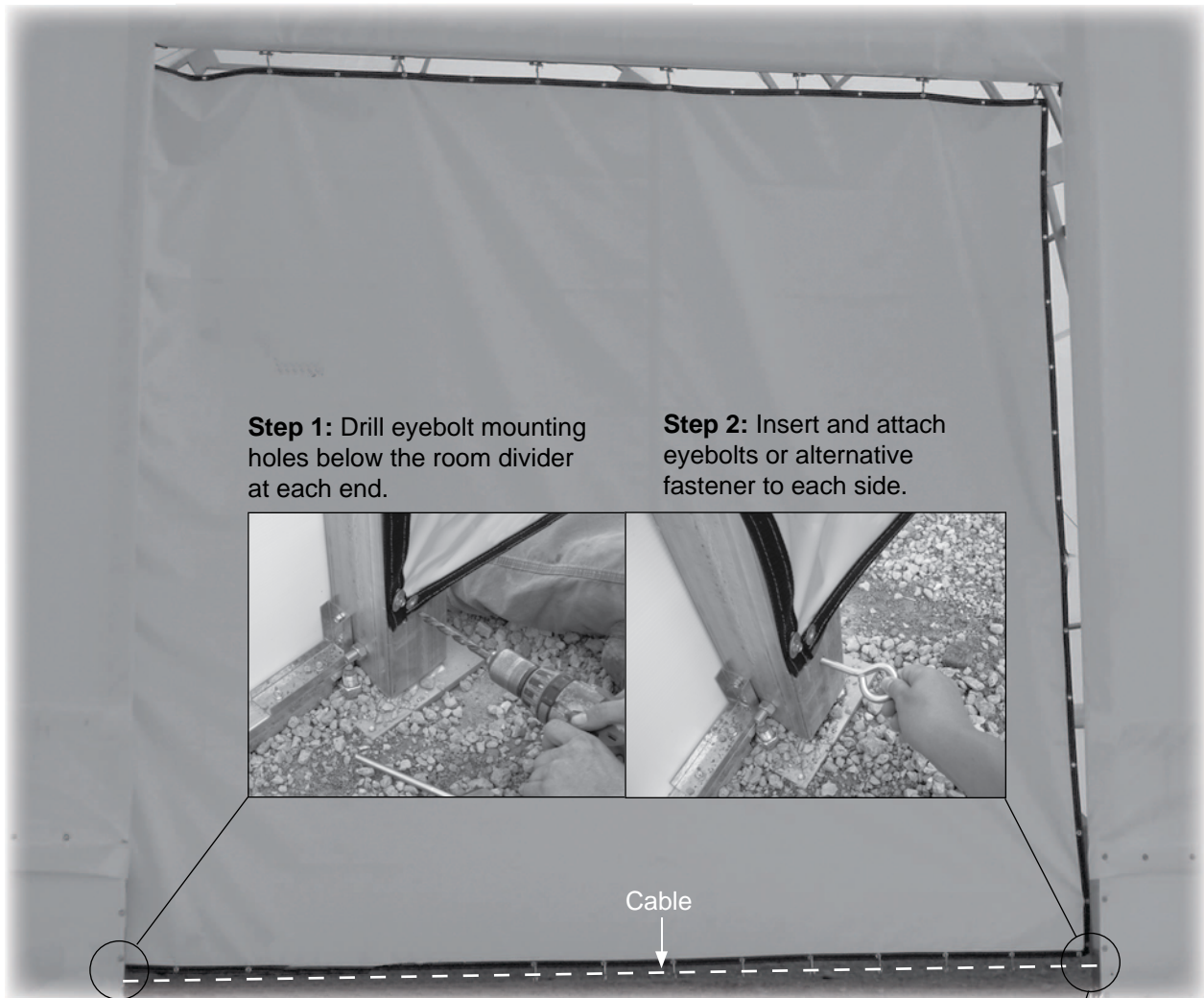

Step 1: Drill eyebolt mounting holes below the room divider at each end.

Step 2: Insert and attach eyebolts or alternative fastener to each side.

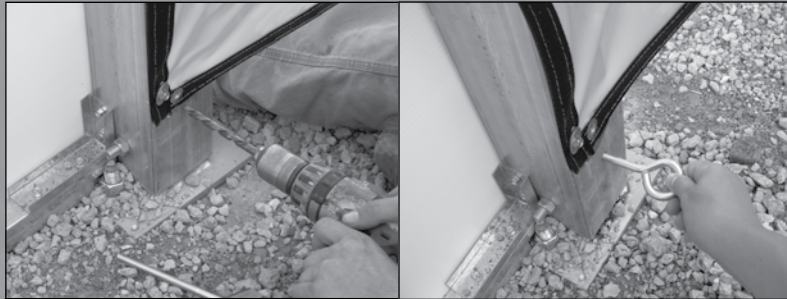

Cable



Step 3: Attach a length of cable to one eyebolt using cable clamps.

Step 4: Thread the free end through the remaining eyebolt, pull tight to remove slack, and attach using cable clamps. Remove excess cable if desired.



Step 5: With the panel in the closed position, secure the grommets in the bottom of the panel to the cable assembly using snap hooks.

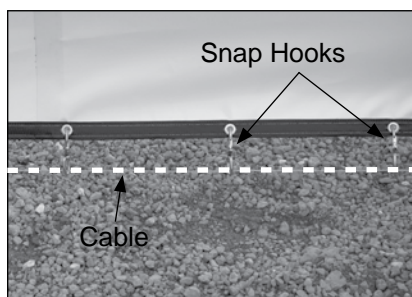

NOTE: If the cable is in the way while the panel is open, attach a clip or snap hook to one end of the cable. To remove the cable, unfasten clip or ring, pull the cable out of the way, and reattach when panel is closed.

CLEARSPAN™ ROOM DIVIDER INSTALLATION

SHELTER CARE AND MAINTENANCE

Proper care and maintenance of your ClearSpan™ Fabric Room Divider and its components is important. Check the following items periodically to properly and adequately maintain your product:

- Regularly check the room divider to see that it remains tight and in proper repair.
- Check the cable and cable clamps to see that these remain tight (if equipped). Tighten as needed.
- Check the cable (if equipped) to verify that it is not worn or wearing on a frame member.
- *Frequently check all components. Replace worn or damaged parts immediately.*
- Check all fasteners frequently to verify that these remain tight and in good repair.
- Use tools that will not damage the divider panel when removing debris and during cleaning.
- Check the building contents to verify that nothing is touching the room divider that could cause damage.
- To prevent damage and possible injury, do not allow the lower end of the panel to remain unsecured when wind is allowed to pass through the building.
- For replacement, missing, or additional parts, call 1-800-245-9881 for assistance.



Space below is reserved for customer notes.