

Strong, Smooth, Quiet – Rolled Into One Great Door

TRAC-RITE®

988
&
988
WL
ROLL-UP DOORS



Performance Counts.

That's why Trac-Rite Door Models 988 and 988WL are ideal for a wide range of commercial uses and large door openings. Their size makes them the popular choice for shipping docks, warehouses, auto body shops, machine shops, farm buildings, post frame buildings, and dozens of other access applications. In addition, Trac-Rite's 988WL windlock system provides maximum wind resistance.

The 988 and 988WL earn high marks for strength. Their solid 26-gauge, rigid-rib steel curtain is durable, attractive, and requires little maintenance. The doors come with a full 3-year materials warranty. The 988 models feature a torque-tube assembly for smooth operation and heavy-duty springs, brackets, and guides.

The 988 and 988WL also score high for quiet operation and ease of installation. They fit almost any large opening since door sizes range from 11'W x 8'H to 16'W x 16'H in 1" increments. With eleven prefinished colors, you are sure to find a door to suit your needs.

Strong. Smooth. Quiet. Versatile. The 988 and 988WL doors earn the highest scores in every area.



Colors vary from actual panel material. Please request a steel color sample for precise shade.



944 944WL 955 955WL 988 988WL

Features.

- Strong, Heavy-Duty Materials
- Smooth, Quiet Operation
- Custom Sizes
- Commercial Applications
- 988WL Withstands Higher Wind Loads
- Low Maintenance
- Minimal Back Room Requirements
- Motor Operator Applications
- Rust Resistant
- 30/25-Year Paint and 3-Year Material Warranties



Dead-axle design with torque-tube assembly allows the door to operate with ease.



As wind blows against the 988WL, the curtain's windlocks engage with the door guide for a strong interlocking grip. This grip keeps the curtain securely in the guide.



Saddle with tensioner device makes adjusting the door tension easier, safer, and quicker than clamp and bracket designs.



Chain hoist mounts directly to the axle for easy installation. 8:1 reduced-drive allows for smooth operation.



Dual 12-gauge, zinc-coated interior steel latches slide into door guide brackets. Latches may also be padlocked for added security.

TRAC-RITE®

988/988WL
ROLL-UP DOORS



Mounting Surface & Door Clearance Requirements.

Measure the following areas to design a 988 or 988WL door to your specific needs.

Framed Opening.

Measure the framed opening.

A = Width

_____ "

B = Height

_____ "

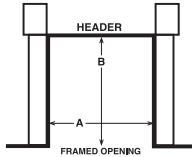

The 988 and 988WL doors are available in custom sizes from 11'W x 8'H to 16'W x 16'H in 1" increments.

FOR EXAMPLE: If your framed opening is 14'6" wide and 16'0" high, you would order a 14'6" x 16'0" (width first, height second) door.

Mounting Surfaces.

Measure the mounting surface areas.

NOTE: All mounting surfaces must be flush.

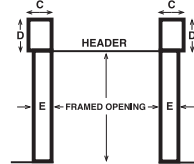

Minimum Mounting Surface Areas

Your Measurement

Brackets

5"

_____ "

C = Width

13"

_____ "

D = Height

Guides

3" (5" masonry jambs)

_____ "

E = Width

Door Clearance.

Measure the door clearance.

NOTE: Insulated doors require an additional 1" of back room and head room.

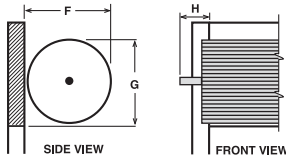

Minimum Clearance

988 = 20" / 988WL = 21"

Your Measurement

_____ "

F = Back Room

988 = 22" / 988WL = 23"

_____ "

G = Head Room

988 / 988WL = 7 1/2"

_____ "

H = Side Room

(22" for motor operator)

Accessories.

- Jamb Brush Seal
- Header Draft Stop
- Exterior SpaceGuard Latch
- SpaceGuard Cylinder Lock
- Insulation
- Hood
- Space-Saving Motor Operator



Wind Load Ratings.

Tested and certified by an independent lab.

988WL Door Width 988WL PSF Rating

11'0"	32.0
12'0"	29.0
13'0"	24.0
14'0"	24.0
15'0"	21.0
16'0"	21.0

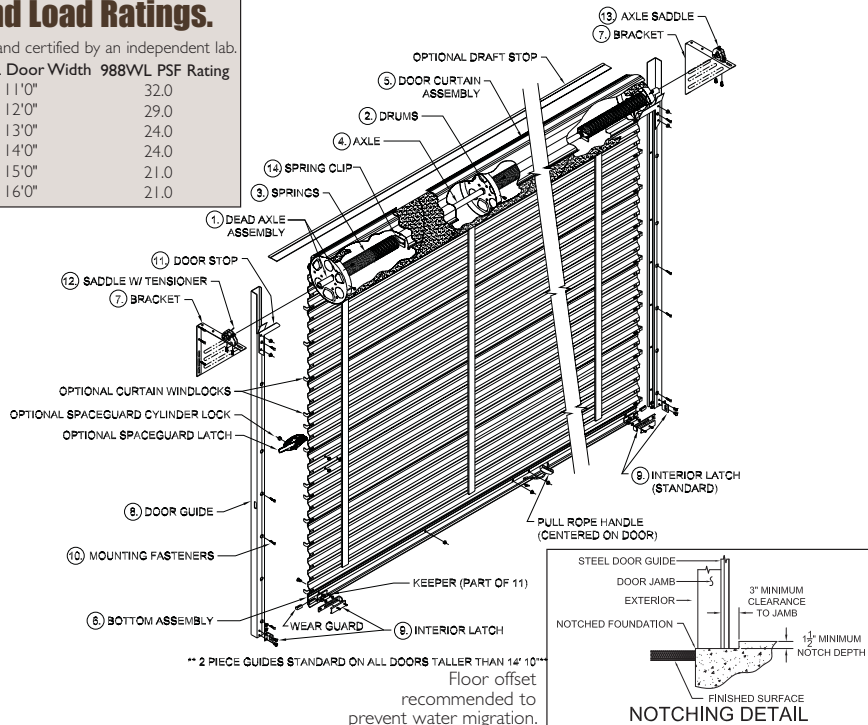

** 2 PIECE GUIDES STANDARD ON ALL DOORS TALLER THAN 14' 10"

Floor offset recommended to prevent water migration.

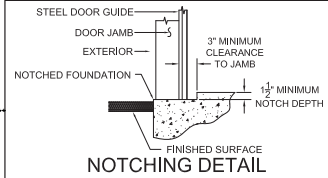

Specifications.

DESIGN TYPE Dead-axle design with torque-tube assembly. Rotates on a fixed axle during operation.

TORQUE-TUBE ASSEMBLY Axle is high-yield structural tubing with 1-5/16" outside diameter. Drums are 12" diameter spiral x 1-1/2" wide, 16-gauge, zinc-coated steel with grease-filled ball bearings mounted in the center of the drum to promote smooth operation. Springs are helical torsion, oil tempered, and factory lubricated to increase life cycle. Axle, drums, and springs are enclosed in a 26-gauge galvanized spiral tube to provide even curtain support.

CURTAIN Roll-formed sections, factory seamed from 26-gauge, Grade 80 galvanized steel. Siliconized polyester finish in eleven standard colors. Full-length 2" felt tape for smooth rolling and reduced marring.

BOTTOM ASSEMBLY Seal-Rite pliable bulb and blade astragal integrated into galvalume bottom bar with stiffening angle.

BRACKETS Universal mounting brackets are interchangeable for mounting on the left or right side. 10-gauge, cold-formed, galvanized steel, embossed for added strength.

SADDLE WITH TENSIONER Easily adjustable one-piece saddle accepts 1-5/16" diameter axle. Double cams lock the axle in position and maintain tension on the springs.

GUIDES 16-gauge, zinc-coated, 2-3/4" deep. Featuring polypropylene guide runners to assure smooth operation and prevent steel-on-steel contact.

988WL CURTAIN WINDLOCKS 10-gauge, zinc-coated steel, secured to door with two 3/16" rivets.

988WL WINDLOCK BAR Galvanized, 12-gauge, with holes for fastening to jamb every four inches. Placed inside the guide.

CHAIN HOIST 8:1 reduced-drive. Mounts directly to the axle on either the left or right side.

INTERIOR LATCHES 12-gauge, zinc-coated steel slide bolt engages a lock strike attached to the side guide. Two latches per door fasten to the bottom assembly and are suitable for padlocking.

MOUNTING FASTENERS Steel or wood fasteners included. For masonry openings, mounting clips and anchoring system are sold separately.

DOOR STOP 12-gauge, zinc-coated, L-shaped door stops. Mount to guides.

Note: Product specifications are subject to change without notice.



For more information

PHONE 800 448 8979
FAX 800 236 8722
WEBSITE www.tracrite.com
EMAIL tr@tracrite.com
ADDRESS 314 Wilburn Road
Sun Prairie, WI 53590

© Trac-Rite 2295.mkt.0310